

BEST 450

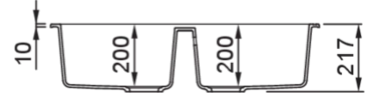

Technical Drawing

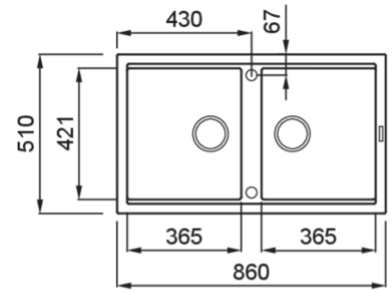

0

Description 2-bowl sink

Model BEST 450

Base (mm) 900

0 Inset

Dimensions (mm) 860 x 510

Hole for built-in installation (mm) 840 x 480

Number of Bowls 2

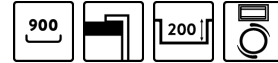

0

Gross Weight (kg) 20,96

Net Weight (kg) 14,70

Packaging Dimension (kg) 940 x 575 x 300

0 (kg) 0,162

0

Packaging Cardboard and polyethylene

0 Space-saving siphon, integrated Flow Pro, rectangular overflow and hooks.

KERATEK



LKB45086 K86
8031873020132



LKB45093 K93
8031873026516



LKB45095 K95
8031873025830



LKB45096 K96
8031873020156



LKB45097 K97
8031873026547



LKB45099 K99
8031873026561

GRANITEK

METAL



LMB45073 M73
8032861953722



LMB45079 M79
8032861953746

GRANITEK

MATT



LGB45040 G40
8032861045274



LGB45043 G43
8032861044857



LGB45048 G48
8032557030799



LGB45068 G68
8032861043461



LGB45078 G78
8032557066927

GRANITEK

CLASSIC



LGB45051 G51
8032861043416



LGB45059 G59
8032861043393



LGB45062 G62
8032861047094

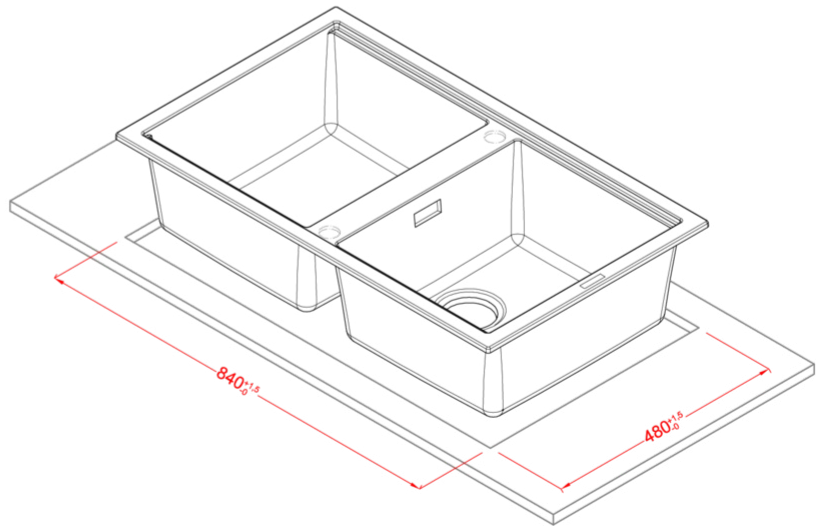
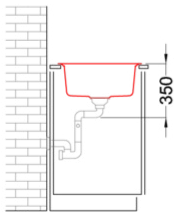
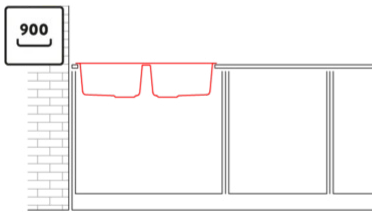
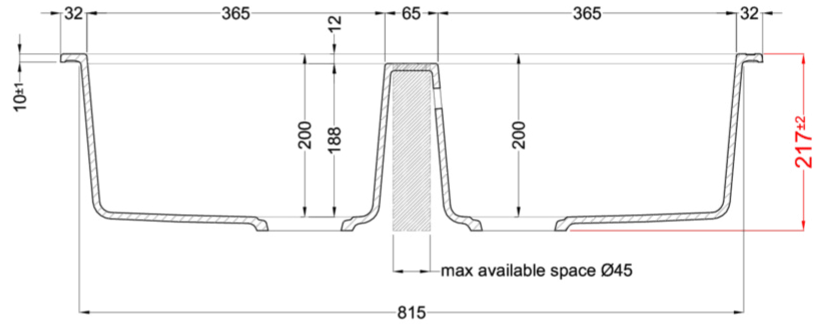
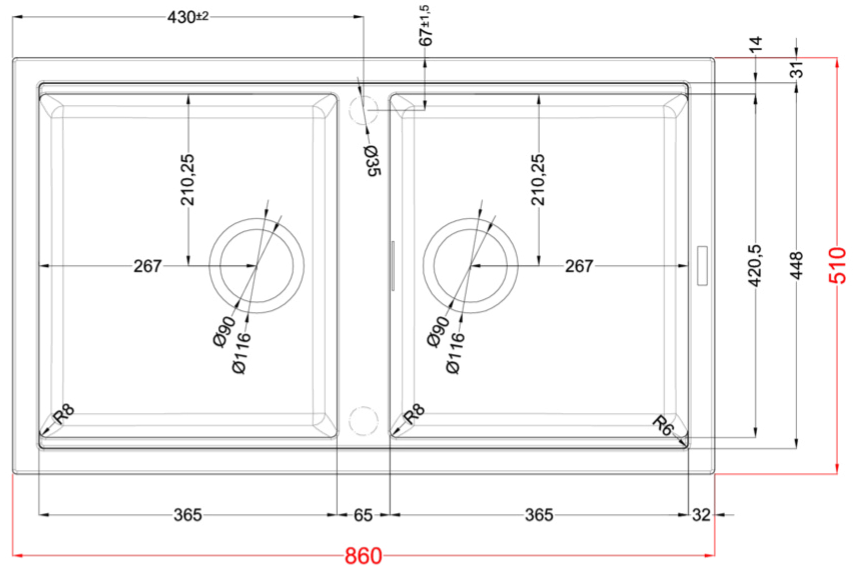
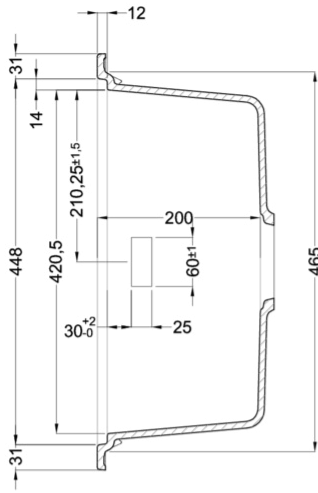

BEST 450

general tolerances where not expressly communicated $\pm 0.2\%$
connection dimensions according to UNI EN 695

