

EASY 500

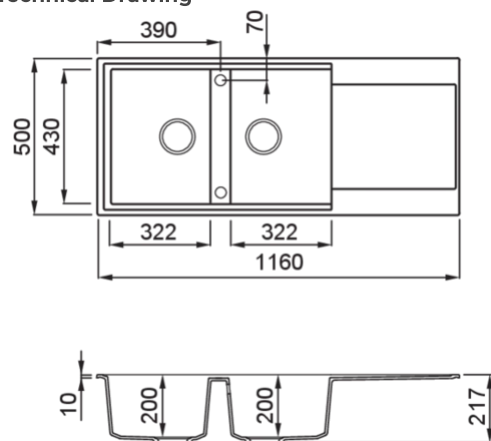

Technical Drawing



0

Description	2-bowl sink with drainer
Model	EASY 500
Base (mm)	800
0	Inset
Dimensions (mm)	1160 x 500
Hole for built-in installation (mm)	1140 x 480
Number of Bowls	2



0

Gross Weight (kg)	23,44
Net Weight (kg)	16,90
Packaging Dimension (kg)	1250 x 575 x 300
0 (kg)	0,216

0

Packaging	Cardboard and polyethylene
0	Space-saving siphon, wastes and hooks.

GRANITEK

METAL



LMY50073 M73
8031873110949



LMY50079 M79
8031873110963

GRANITEK

MATT



LGY50040 G40
8032557033134

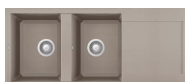

LGY50043 G43
8032557038375



LGY50048 G48
8032557035121



LGY50068 G68
8032557033127

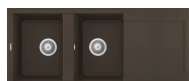

LGY50078 G78
8032557067429

GRANITEK

CLASSIC



LGY50051 G51
8032557033097



LGY50059 G59
8032557038382



LGY50062 G62
8032557033110

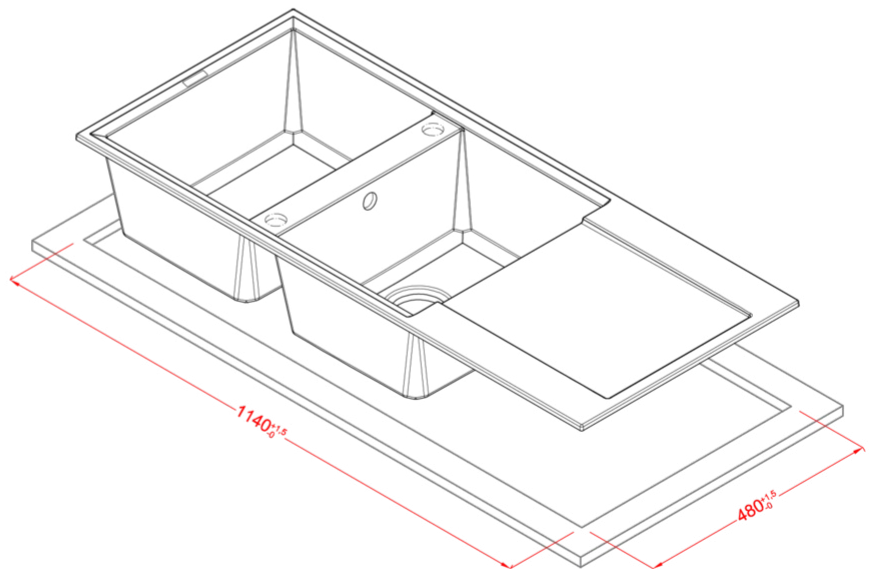
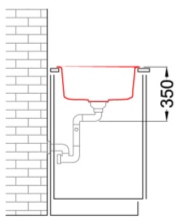
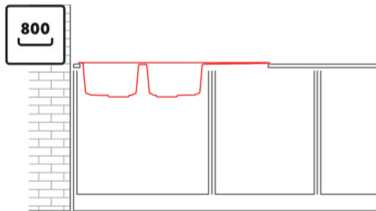
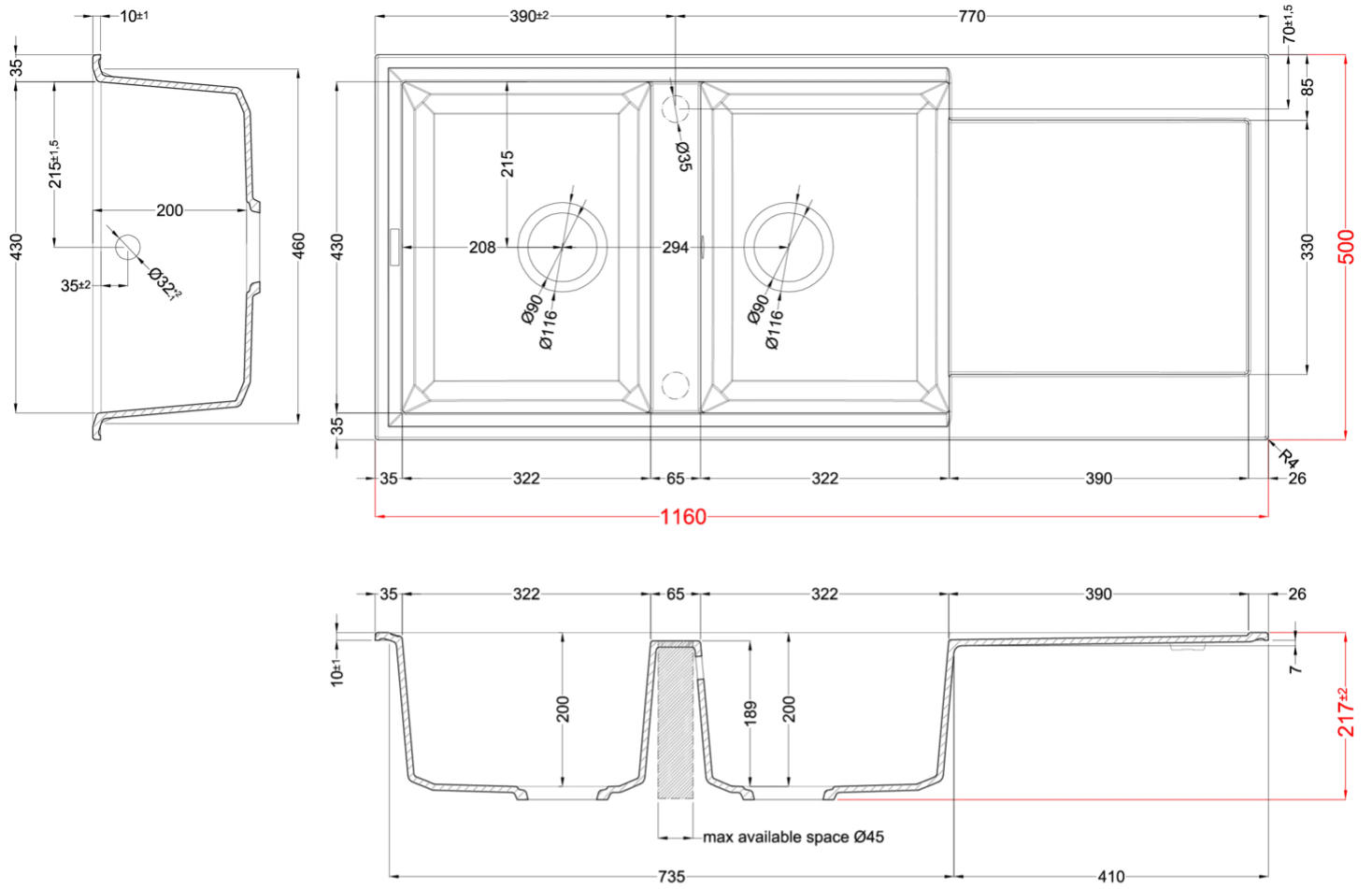

Easy 500

general tolerances where not expressly communicated ± 1 mm
 connection dimensions according to UNI EN 695
 eventual exceptions are reported with *

elleci