

INTEGRA 102

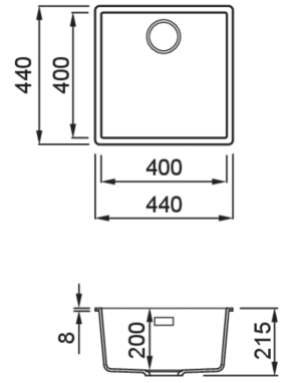

Technical Drawing



0

Description	1-bowl sink
Model	INTEGRA 102
Base (mm)	500
0	Integrated and Undermount
Dimensions (mm)	440 x 440
Hole for built-in installation (mm)	400 x 400 R5
Number of Bowls	1
Bowl Depth (mm)	215



0

Packaging Dimension (kg)	575 x 575 x 300
---------------------------------	-----------------

0

Packaging	Cardboard and polyethylene
------------------	----------------------------

0

	Space-saving siphon, integrated Flow Pro, rectangular overflow and undermount kit.
--	--

KERATEK



LKQ10293BIN K93
8032557027218

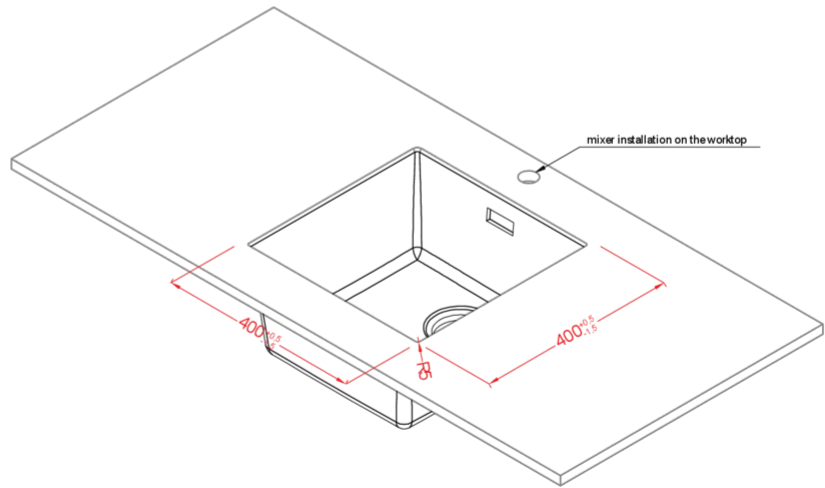
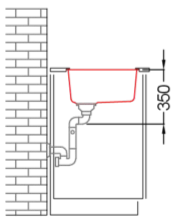
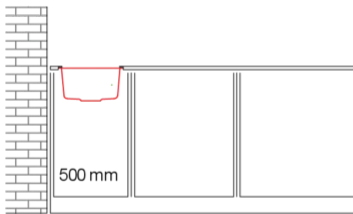
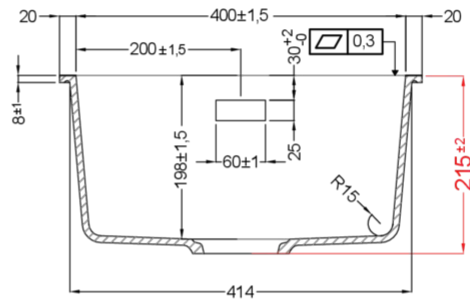
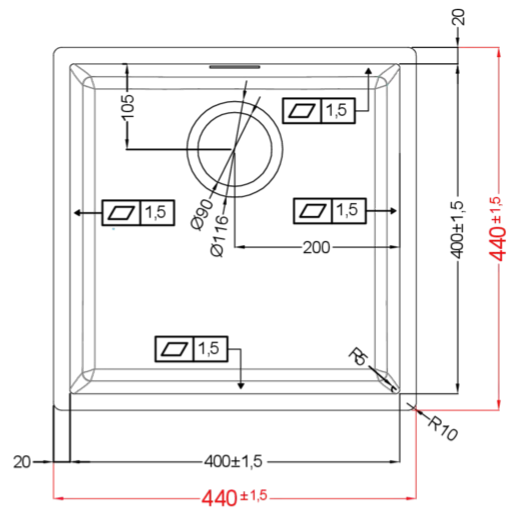
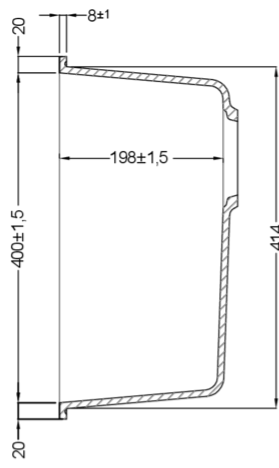

Integra 102 Integrated

general tolerances where not expressly communicated ± 1 mm
 connection dimensions according to UNI EN 695
 eventual exceptions are reported with *

elleci