

## TOURMALINE PLUS

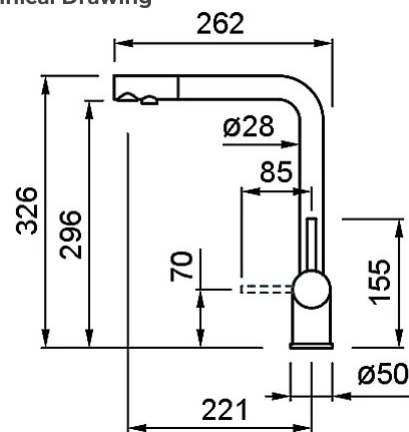

### Technical Drawing



#### FEATURES

##### Description

**Model** TOURMALINE PLUS

**Base (mm)** 50

( $\varnothing$ mm) 35

360°

**Flexi-hose** Stainless Steel 3/8"

( $\varnothing$ mm) 35

#### LOGISTIC DATA

**Gross Weight (kg)** 1,49

**Net Weight (kg)** 0,90

**Packaging Volume (kg)** 0,012

#### PACKAGING FEATURES

**Packaging** Cardboard box

## KERATEK



**MKKTOP86** K86  
8031873005108



**MKKTOP96** K96  
8031873005115

## GRANITEK



**MGKTOP40** G40  
8031873005061



**MGKTOP51** G51  
8031873005078



**MGKTOP68** G68  
8031873005085

**INOX**



**MIKTOPIN IN**  
8031873005092